



**PIATRAONLINE - SKIN FLEXIBLE STONE VINEER – CLEANING, SEALING & AFTERCARE**

**CONDITIONING CLEANING, SEALING & AFTER CARE GUIDE**

The following is a cleaning and sealing guide for skin flexible stone veneer. The products and methods specified should ensure that surfaces are suitably conditioned before sealing. Future cleaning and aftercare then made easier following the application of a water based impregnating sealer or to finish the surface with a satin finish.



**CLEANING....**

**1. CONDITIONING & CLEANING THE SURFACE AFTER FIXING & BEFORE SEALING**

**LTP GRIMEX**

LTP Grimex is a high performance product for stripping and cleaning of vitrified glazed ceramics, porcelain, travertine, natural stone, sandstone, slate, marble, granite, terracotta, quarry, brick, concrete, external paving, terrazzo and other mineral floors & walls. On larger areas scrubber drier machines can be used.



APPLICATION	1ltr	5ltr	25ltr
Surface Cleaning	60 M <sup>2</sup> Per Bottle	300 M <sup>2</sup> Per Bottle	1500 M <sup>2</sup> Per Bottle
Deep Stripping	30 M <sup>2</sup> Per Bottle	150 M <sup>2</sup> Per Bottle	750 M <sup>2</sup> Per Bottle
In Extreme Cases	15 M <sup>2</sup> Per Bottle	75 M <sup>2</sup> Per Bottle	375 M <sup>2</sup> Per Bottle

**TECHNICAL FEATURES**

- Non hazardous
- High performance
- Fast acting
- Easy to use
- Walls & floors
- Interior & exterior use
- Deep cleaning

**DIRECTIONS FOR USE MANUAL APPLICATION: FLOORS**



**STEP 1.**  
Dilute solution 1 : 10 with cool water. Mask and protect areas not to be cleaned.

**STEP 2.**  
Apply to the surface working in manageable areas at a time.

**STEP 3.**  
Add a little water and gently scrub surfaces with a white pad to release the loosened matter from the surface.

**STEP 4.**  
Sponge up and extract released residues. Go over 2 further times with clean water. Change rinsing water frequently.

**STEP 5.**  
Gently buff dry with a soft cloth. Do not allow any traffic before sealing.

*This information is offered without guarantee. The material should be used so as to take account of the local conditions and the surfaces to be treated. In case of doubt, the product should be tried out in an inconspicuous area*



For any LTP product information call our technical helpline +44 (0) 1823 666213  
Visit our website [www.ltp-online.co.uk](http://www.ltp-online.co.uk)





## CLEANING (cont)...

### DIRECTIONS FOR USE MANUAL APPLICATION: WALLS



**STEP 1.**  
Dilute solution 1 : 1 with cool water. Mask and protect areas not to be cleaned.



**STEP 2.**  
Apply to the surface using a soft cloth soaked in the dilute solution making sure to work in manageable areas at a time.



**STEP 3.**  
Add a little water and gently scrub surfaces with a white pad to release any loosened matter from the surface.



**STEP 4.**  
Sponge to extract released residues. Rinse with water a second time and extract again.

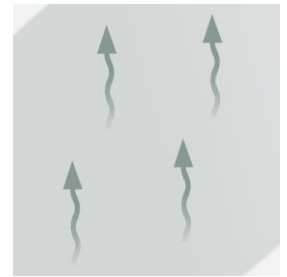

**STEP 5.**  
Gently buff with a soft cloth until dry.

### FURTHER INFORMATION – CONDITIONING CLEANING:

Try to work in manageable areas at a time and make sure to rinse well with plenty of water after each application. Rinsing should be repeated at least 2 times after cleaning.

**USEFUL EQUIPMENT:** White pad, pad holder & 4pc pole, scrubbing brush, buckets, sponges, absorbant towels (for spillage control), Plastic film and masking tape for covering and protecting any surfaces not to be cleaned. Mop and bucket for rinsing.

Ensure that any sensitive surfaces not to be cleaned are properly covered and protected before beginning. Ensure that gloves and eye protection and suitable water proof clothing are worn at all times. If potable water is used for rinsing we would suggest changing the water after every 5 M<sup>2</sup>.

*This information is offered without guarantee. The material should be used so as to take account of the local conditions and the surfaces to be treated. In case of doubt, the product should be tried out in an inconspicuous area*



For any LTP product information call our  
technical helpline +44 (0) 1823 666213  
Visit our website [www.ltp-online.co.uk](http://www.ltp-online.co.uk)





## SEALING OPTION 1...

### 2. PROTECTING THE STONE VENEER AFTER CONDITIONING (minimal change to appearance)



#### LTP MATTSTONE H2o

Solvent based or water based impregnating sealers. Dry to leave surfaces with colour enhanced or natural finish. Help to protect against staining. Treated surfaces strongly repel water, oil and grease. These products allow surfaces to breathe. Ideal for protecting porous surfaces that do not have a damp proof course. These products are non film forming.

APPLICATION	500 ml	1 ltr	5 ltr
Spirit based	5 M <sup>2</sup> Per coat	10 M <sup>2</sup> Per coat	50 M <sup>2</sup> Per coat
Water based	7.5 M <sup>2</sup> Per coat	15 M <sup>2</sup> Per coat	75 M <sup>2</sup> Per coat

#### TECHNICAL FEATURES

- Spirit based
- Water based
- High performance
- Natural finish
- Easy to apply
- Interior & exterior use
- Breathable

### DIRECTIONS FOR USE APPLYING IMPREGNATING SEALER: FLOORS



**STEP 1.**  
Apply sealer to the surface.

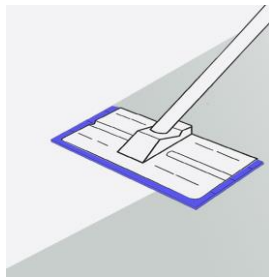

**STEP 2.**  
Spread out evenly using a sealant applicator.

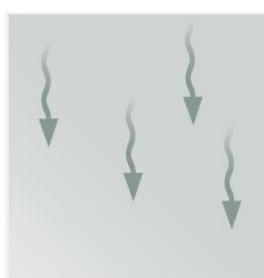

**STEP 3.**  
Allow sealer to absorb and dry naturally.

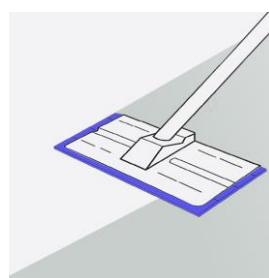

**STEP 4.**  
Apply further coats until the surface is completely saturated.



**STEP 5.**  
Newly sealed surfaces should be left to dry for a minimum of 12 hours before allowing heavy traffic.

### DIRECTIONS FOR USE APPLYING IMPREGNATING SEALER: WALLS

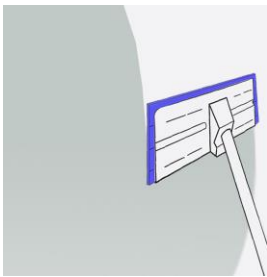

**STEP 1.**  
Apply sealer to the surface of the stone & spread out evenly using a sealant applicator.

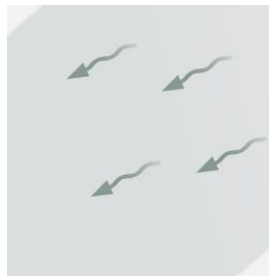

**STEP 2.**  
Allow sealer to absorb naturally.

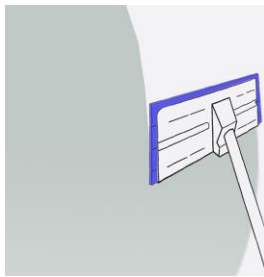

**STEP 3.**  
Apply further coats at 30 minute intervals until the stone is fully saturated.

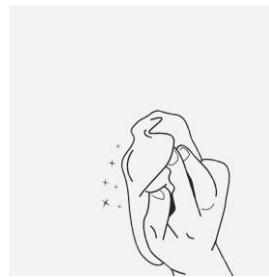

**STEP 4.**  
45 minutes after applying the final coat of sealer dry buff the surface to finish.

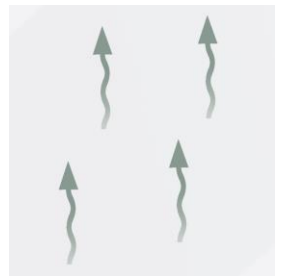

**STEP 5.**  
Newly sealed and finished surfaces should be left to dry. Keep dry for a minimum of 24 hours.

*This information is offered without guarantee. The material should be used so as to take account of the local conditions and the surfaces to be treated. In case of doubt, the product should be tried out in an inconspicuous area*



For any LTP product information call our technical helpline +44 (0) 1823 666213  
Visit our website [www.ltp-online.co.uk](http://www.ltp-online.co.uk)





## SEALING OPTION 2...

### 3. PROTECTING THE SURFACE OF STONE VENEER WITH A SATIN FINISH (enhances the appearance)



#### LTP GLAZE PROTECTOR

A low maintenance heavy duty film forming sealer for low and non porous surfaces. Suitable for polished and unpolished concrete toppings, natural stone veneer, glazed ceramic, porcelain, unpolished porcelain and vitrified quarry tiles. Protects and embellishes the surface. Highly resistant to wear and stains. Binding qualities help to prevent dusting and degradation of the surface. Facilitates cleaning and aftercare. Not suitable for wet areas such as steam rooms or shower enclosures.

APPLICATION	1 ltr	5 ltr	25 ltr
Low porosity surfaces	30 M <sup>2</sup> Per coat	150 M <sup>2</sup> Per coat	750 M <sup>2</sup> Per coat

#### TECHNICAL FEATURES

- Non hazardous
- High performance
- Satin finish
- Easy to apply
- Interior use
- Low odour VOC free

### DIRECTIONS FOR USE APPLYING SATIN FINISH SEALER: FLOORS

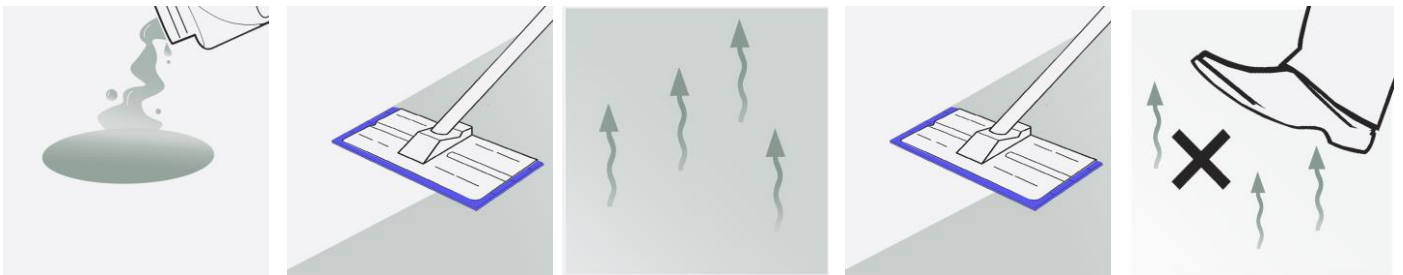

**STEP 1.**  
Ensure surface to be treated is clean and as dry as possible before pouring the sealer onto the surface.

**STEP 2.**  
Spread out evenly and thinly using a sealant applicator pad.

**STEP 3.**  
Allow sealer to dry for a minimum of 45 minutes. Do not rub or buff the surface while it is drying.

**STEP 4.**  
Repeat process by applying 2 further coats and leave to dry.

**STEP 5.**  
Newly sealed and finished surfaces should be left to dry for a minimum of 12 hours before allowing traffic.

### DIRECTIONS FOR USE APPLYING SATIN FINISH SEALER: WALLS

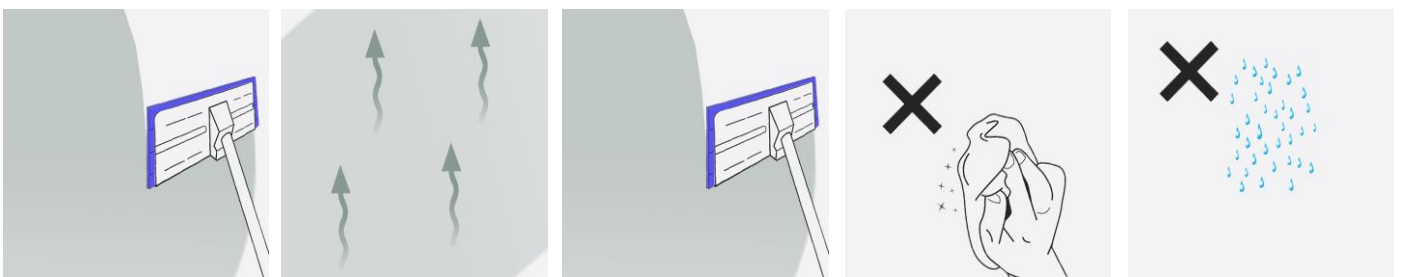

**STEP 1.**  
Apply sealer to the surface of the stone & spread out evenly using a sealant applicator.

**STEP 2.**  
Allow sealer to dry naturally.

**STEP 3.**  
Apply further coats at 30 minute intervals until the desired finish has been achieved.

**STEP 4.**  
Do not buff or rub the surface to finish.

**STEP 5.**  
Keep dry for a minimum of 24 hours.



For any LTP product information call our technical helpline +44 (0) 1823 666213  
Visit our website [www.ltp-online.co.uk](http://www.ltp-online.co.uk)





## FURTHER INFORMATION - SEALING:

Ensure that any surfaces not to be treated are properly covered and protected before beginning.

LTP Glaze Protector will make surfaces appear much darker following treatment.

Do not buff or rub the LTP Glaze Protector sealer between coats. Apply several coats until the desired finish has been achieved (Min 3. Max 6)

LTP Glaze Protector is not suitable for use in areas that have prolonged contact with water such as bathrooms and wetrooms.

If the sealing products are to be used in areas where food is consumed: Once cured they are completely inert, so therefore considered to be food safe. In areas of high traffic it may be necessary to apply a top up coat of protection every 3 – 4 years. Use LTP Waxwash cleaner for floors and LTP Stonewash cleaner for walls. Surfaces sealed with LTP Glaze Protector should be routinely cleaned with LTP Floorshine. If correct aftercare is used for the daily/weekly cleaning, then a top up coat can be applied whenever necessary without the need to strip the surface back.

**USEFUL EQUIPMENT:** 4pc pole, pad holder, sealant applicator pad, microfibre buffing cloth, Plastic film and masking tape for covering and protecting any surfaces not to be sealed.

## AFTERCARE...

### 4. PH NEUTRAL DAILY/WEEKLY CLEANING NATURAL STONE VENEER FLOORS



#### LTP WAXWASH FOR SURFACES SEALED WITH LTP MATTSTONE H2O LTP FLOORSHINE FOR SURFACES SEALED WITH LTP GLAZE PROTECTOR

A gentle cleaner especially formulated to clean without damaging the most delicate surfaces. Cleans without removing the protective seal or damaging the tile, leaving surfaces with a fresh clean fragrance. Suitable for use on sealed, and un-sealed, polished and unpolished surfaces. Can also be used in scrubber drier machines. For more information refer to the technical data sheet.

APPLICATION	1 ltr	5 ltr	25 ltr
20 M <sup>2</sup> surface	40 washes approx	200 washes approx	N/A

#### TECHNICAL FEATURES

- Environmentally friendly
- PH Neutral
- Phosphate free
- Non film & film forming
- Commercial & domestic
- Sealed and unsealed surfaces
- Fresh clean fragrance
- Interior & exterior use

### DIRECTIONS FOR USE: MANUAL APPLICATION



**STEP 1.**  
Dilute 1 capful of cleaner per litre of water.



**STEP 2.**  
Mop surfaces with the solution.

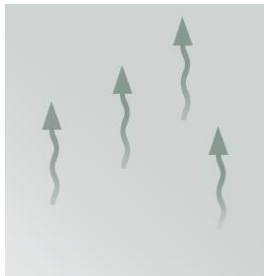

**STEP 3.**  
No need to rinse. Leave surfaces to dry.

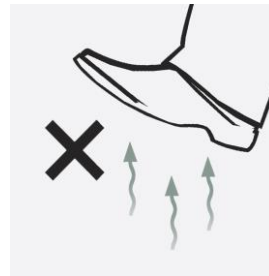

**STEP 4.**  
Keep off of surfaces until they are completely dry.

**Concentrated  
Formula  
Up to  
40 Washes  
From 1 litre**

*This information is offered without guarantee. The material should be used so as to take account of the local conditions and the surfaces to be treated. In case of doubt, the product should be tried out in an inconspicuous area*



For any LTP product information call our  
technical helpline +44 (0) 1823 666213  
Visit our website [www.ltp-online.co.uk](http://www.ltp-online.co.uk)





## AFTERCARE(cont)...

### PH NEUTRAL DAILY/WEEKLY CLEANING NATURAL STONE MOSAIC WALLS



#### LTP STONEWASH SPRAY

Spray and wipe ph neutral cleaning for delicate and sealed surfaces. Cleans without compromising the protection offered impregnating sealers or damaging the surface of the stone. This cleaner can also be used on stone work tops, glass, stainless steel, wood, laminate and sanitary ware.

APPLICATION	500 ml	1 ltr	5 ltr
Daily Surface Cleaning	Approx 1 month use	N/A	N/A
Weekly Surface Cleaning	Approx 6 months use		

#### TECHNICAL FEATURES

- PH Neutral
- Non hazardous
- Non film forming
- Commercial & domestic
- All hard surfaces
- Interior & exterior use

### DIRECTIONS FOR USE: MANUAL APPLICATION

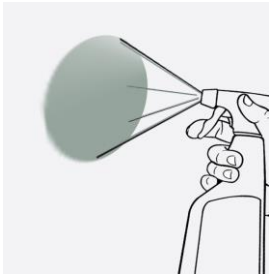

**STEP 1.**  
Spray a small amount of cleaner onto the surface.



**STEP 2.**  
Wipe over the surface using a damp cloth.

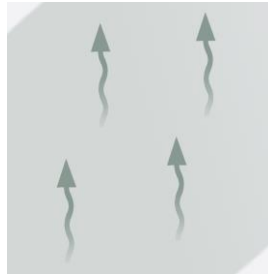

**STEP 3.**  
Leave surfaces to dry naturally.



**STEP 4.**  
Do not rinse.

### FURTHER INFORMATION - AFTERCARE:

Using the correct cleaner will help reinforce protection offered by impregnating sealers. Avoid using steam cleaners and strong alkali or acid based cleaning detergents on natural stone as they will gradually break down the protective treatment and cause damage to the stone surface.

Cleaning surfaces routinely with a PH neutral cleaner should ensure that surfaces remain suitably protected for many years. Cleaning surfaces sealed with LTP Glaze Protector should ensure that surfaces are kept clean and the finish replenished after every wash.

If the surface is kept clean then a top up coat of sealer can be applied without the need to intensively clean using a stronger cleaner first.

Neglected or grubby looking surfaces can be restored by intensively cleaning using **LTP Grimex**. If mould and mildew is an issue use then use **LTP Mouldex** to kill and remove any mould spores. Always reseal any stone surface that has been intensively cleaned.

*This information is offered without guarantee. The material should be used so as to take account of the local conditions and the surfaces to be treated. In case of doubt, the product should be tried out in an inconspicuous area*



For any LTP product information call our technical helpline +44 (0) 1823 666213  
Visit our website [www.ltp-online.co.uk](http://www.ltp-online.co.uk)

